

PAR-3 GOLF CLUBHOUSE
PALM BEACH GARDENS, FL

NO. DATE: TITLE/PURPOSE:

2 7/1/2021 Bid Addendum #2

SCALE: 1/8" = 1'-0"

ISSUE DATE: 07/01/2021

PROJECT #: 21005

TITLE: OVERALL FUEL GAS
FLOOR PLAN - FIRST
FLOOR

SHEET #:

FG101

FUEL GAS KEYNOTES	
FG01	HDPE PROPANE GAS LINE TURNS UP TO ABOVE GRADE AND TRANSITIONS TO 3/4"Ø SCHEDULE 40 GALVANIZED STEEL. ONCE ABOVE GRADE, TURN PIPE INTO BUILDING AND ROUTE UP TO CEILING CAVITY. PROVIDE POLY RISER FOR TRANSITION. REFER DETAIL.
FG02	CONTRACTOR SHALL PROVIDE INDOOR RATED 14" W.C MP REGULATOR WITH VENT LIMITER FOLLOWED BY A SHUTOFF VALVE ON VERTICAL PIPE. REGULATOR SHALL KNOCK DOWN PRESSURE FROM 2 PSI TO 14" W.C.
FG04	INSTALL EMERGENCY GAS SHUTOFF PULLSTATION AT THIS LOCATION (MIN. 10' FROM KITCHEN HOOD, MAX. 20')
FG06	COORDINATE FUEL GAS PIPING WITH STRUCTURAL BEAM IN CEILING.
FG07	CONTRACTOR TO COORDINATE LOCATION OF NEW 1000GAL PROPANE TANK WITH OWNER AND/OR OWNERS REP PRIOR TO INSTALLATION.

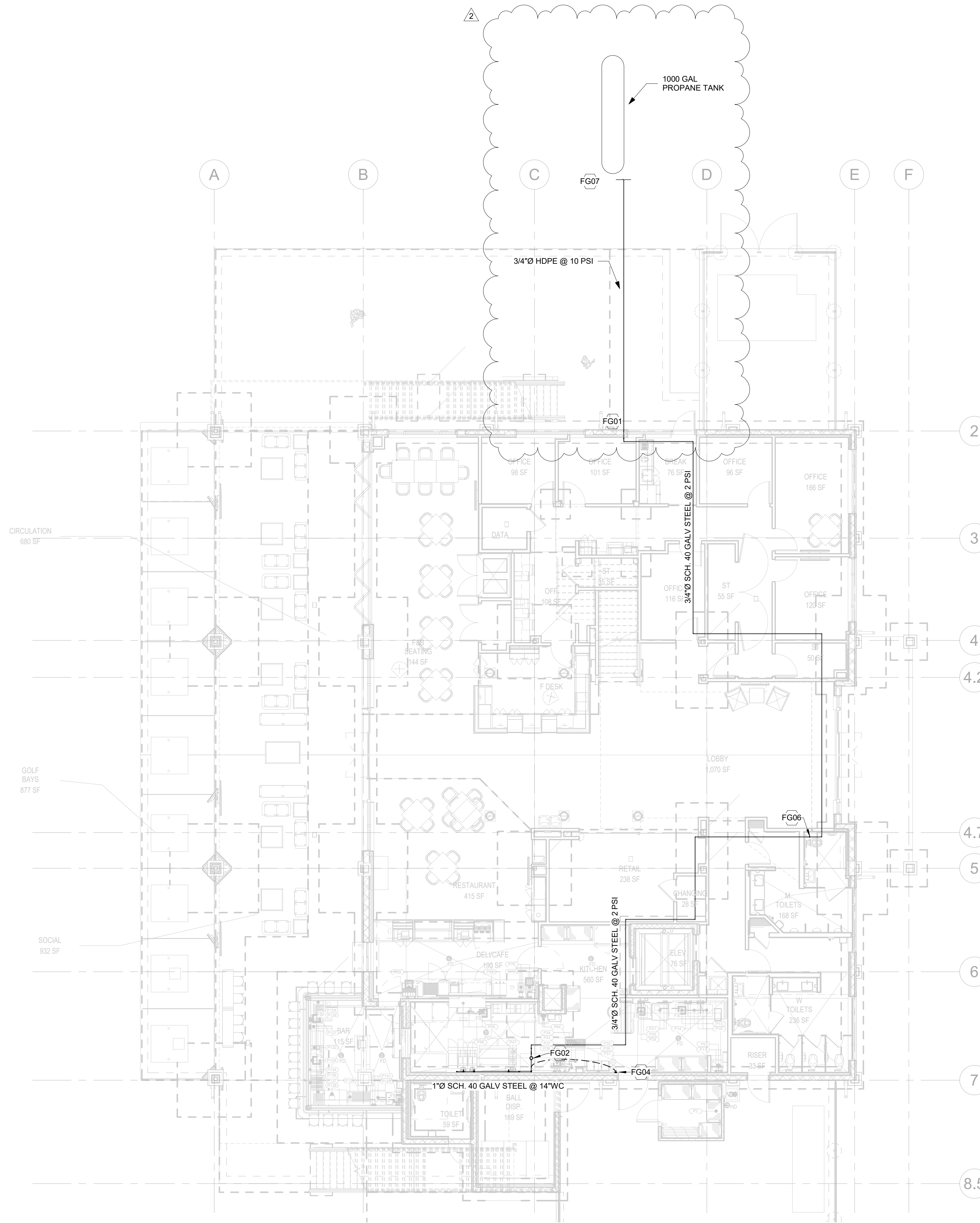

OVERALL FUEL GAS PLAN - FIRST
FLOOR
1/8" = 1'-0"



2295 S HIAWASSEE RD
 SUITE 310
 ORLANDO, FL 32835
 T: 407.992.0470
 www.olcdesigns.com

RGD
 CONSULTING
 ENGINEERS

JUPITER | ORLANDO
 561-743-0165 | 407-845-5630
 WWW.RGDENGINEERS.COM
 2151 ALT A1A #2000, JUPITER, FL 33477
 CERT. OF AUTH. 5454

PAR-3 GOLF CLUBHOUSE
PALM BEACH GARDENS, FL

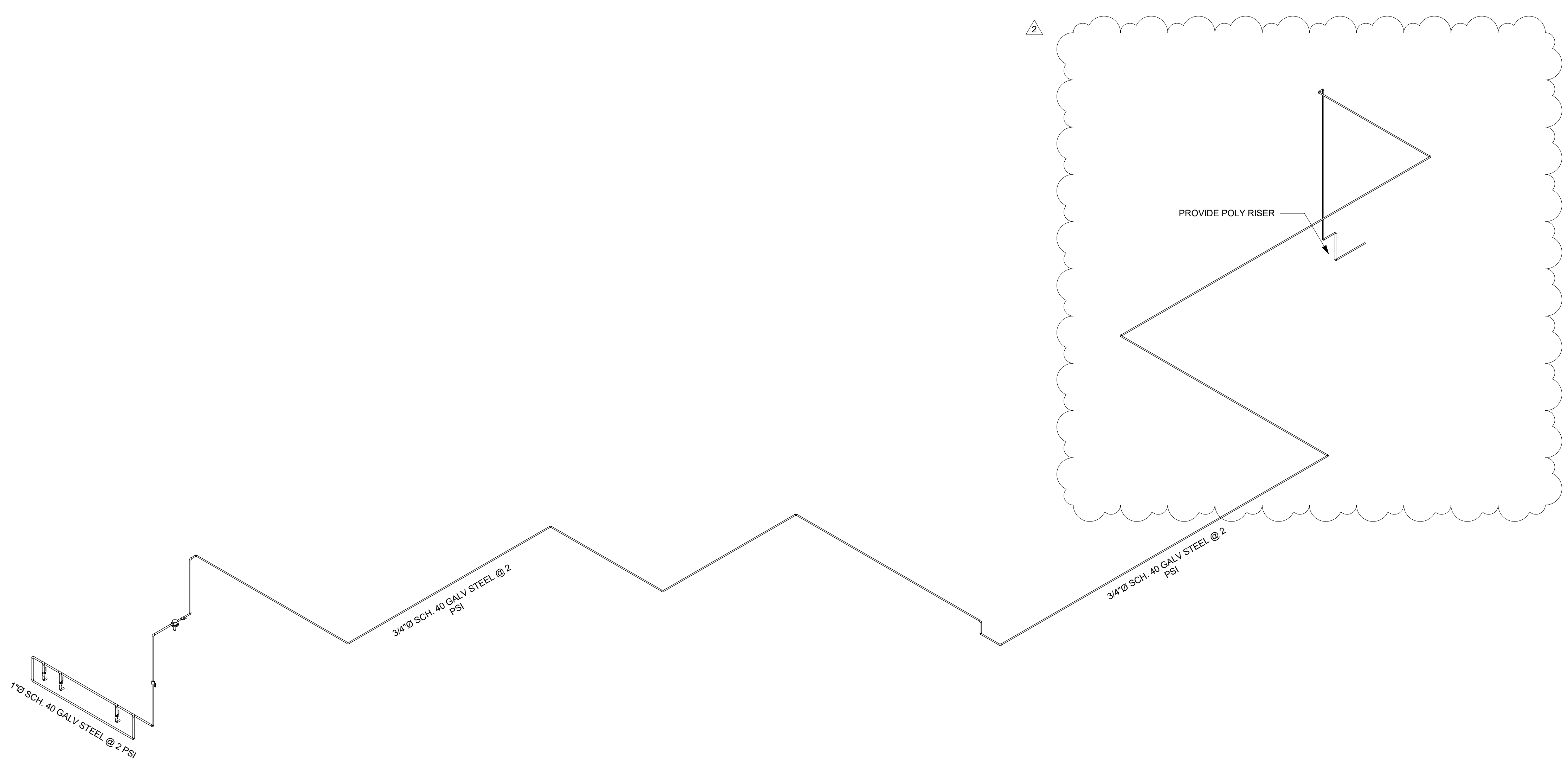

NO. DATE: TITLE/PURPOSE:

NO.	DATE:	TITLE/PURPOSE:
2	7/1/2021	Bid Addendum #2

SCALE:

ISSUE DATE: 07/01/2021

PROJECT #: 21005

TITLE: FUEL GAS ISOMETRIC
 PLAN

SHEET #:

FG201

1 DOMESTIC WATER ISOMETRIC